

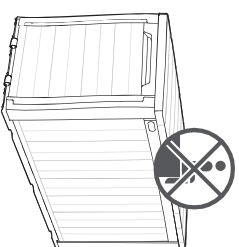

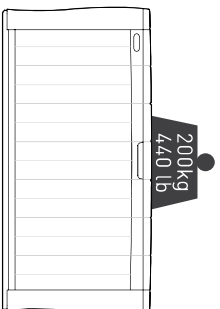

270L | 71 US GAL

ASSEMBLY INSTRUCTIONS ● INSTRUCCIONS DE MONTAGE ● MONTAGEANLEITUNG ● MONTAGEVOORSCHRIFT
 INSTRUCCIONES DE MONTAJE ● ISTRUZIONI DI MONTAGGIO ● INSTRUCÖES DE MONTAGEM ● ΟΔΗΓΙΕΣ ΣΥΝΑΡΜΟΛΟΓΗΣΗΣ

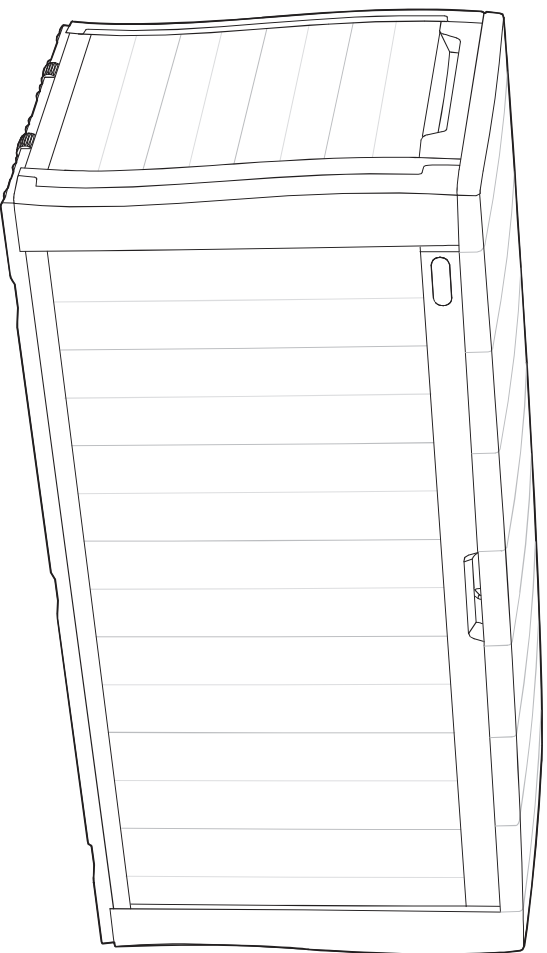

ASSEMBLY PARTS ● PIÈCES À ASSEMBLER ● MONTAGETEILE ● MONTAGESTÜCKEN ● PIEZAS DE ENSAMBLE
 PARTI DA MONTARE ● PEÇAS DE MONTAGE ● ΑΝΤΑΜΑΚΤΙΚΑ

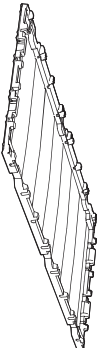
Please check all parts and components to ensure that there are no damages or missing items BEFORE starting the construction of the product. Assurez-vous que les parties et les éléments ne sont pas endommagés et qu'aucun ne manque AVANT de commencer le montage de ce produit. Bitte überprüfen Sie alle Einzelteile und jegliches Zubehör, um sicherzugehen, dass keine Teile beschädigt sind oder fehlen. BEVOR Sie mit der Montage des Produkts beginnen. Controleer alle onderdelen en componenten om te verzekeren dat er geen schade of ontbrekende items zijn VOOR dat u het product in elkaar begint te zetten. ANTES de comenzar la construcción del producto, compruebe todos las partes y componentes para asegurarse de que no hay daños y de que no falta ningún elemento. Si prega di controllare tutti i pezzi ed i componenti per accertarsi che non ci siano danni o elementi mancanti. PRIMA di montare il prodotto. Por favor, verifique todas as peças e componentes para garantir que não há danos ou itens incompletos ANTES de iniciar a construção do produto. Ελέγξτε όλα τα μέρη και εξαρτήματα για να βεβαιωθείτε ότι δεν υπάρχει φθορά ή λείπον τμήματα ΠΡΟΤΟΥ ξεκινήσετε την κατασκευή του προϊόντος.

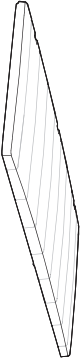
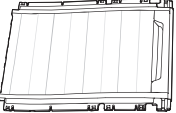
 <p>RB/SW (x1) ①</p>	 <p>F (x1) ④</p>	 <p>W (x2) ⑥</p>
 <p>RB/SW (x1) ③</p>	 <p>RB/SW (x1) ⑤</p>	 <p>RB/SW (x2) ②</p>

- **IMPORTANT:** Please contact Customer Service if you have any problems or discover any missing parts.
- **IMPORTANT:** Veuillez contacter notre Service Clientèle pour tout problème ou pièce manquante.
- **WICHTIG:** Bitte wenden Sie sich an unseren Kundenservice, falls Sie irgendwelche Probleme haben oder feststellen, daß Teile fehlen.
- **IMPORTANTE:** Sírvase contactar con nuestro Servicio al Cliente por cualquier problema o pieza que pudiera faltar.
- **IMPORTANTE:** Si prega di contattare il Servizio Clienti per eventuali necessità.
- **BELANGRIJK:** Neemt u in geval van problemen of missende onderdelen a.u.b. contact op met de klantenservice.
- **IMPORTANTE:** favor entrar em contato com o Serviço ao Cliente se houver problemas ou se faltar peças.
- **ΣΗΜΑΝΤΙΚΟ:** παρακαλώ επικοινωνήστε με την Εξυπηρέτηση Πελάτη αν αντιμετωπίσετε κάποιο πρόβλημα ή αν λείπει μέρος από την συσκευασία.



USA & Canada:
 1-888-374-4242
UK: Tel: 0121-5060008
 Fax: 0121-4220808
Other European Countries:
 Tel: +31-1612-28301,
 Fax: +31-1612-28322
WWW.KETER.COM

- 1 RB/SW (x1)
- RB/SW (x1)
- RB/SW (x2)

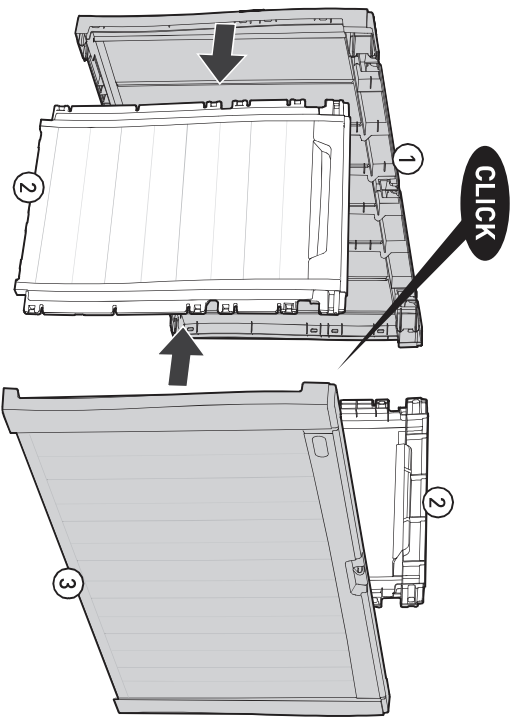

- 3 RB/SW (x1)

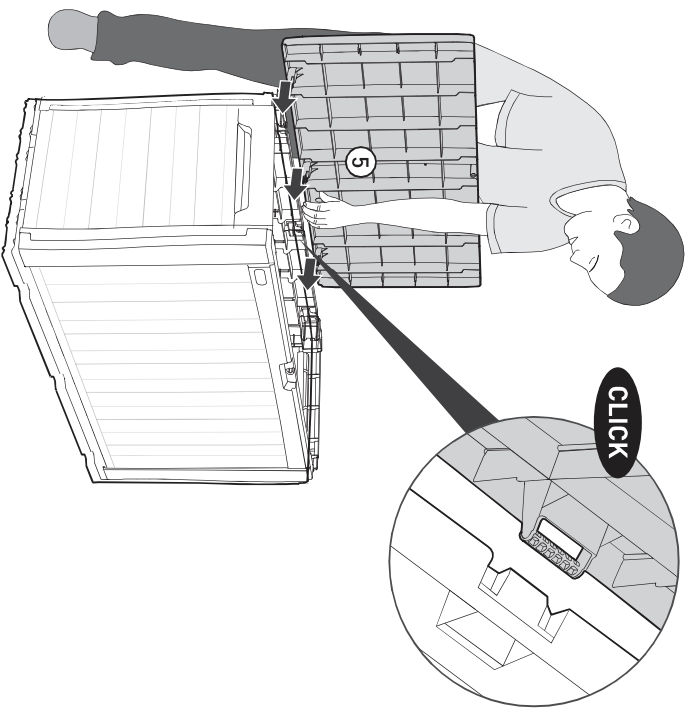

- 2 F (x1)

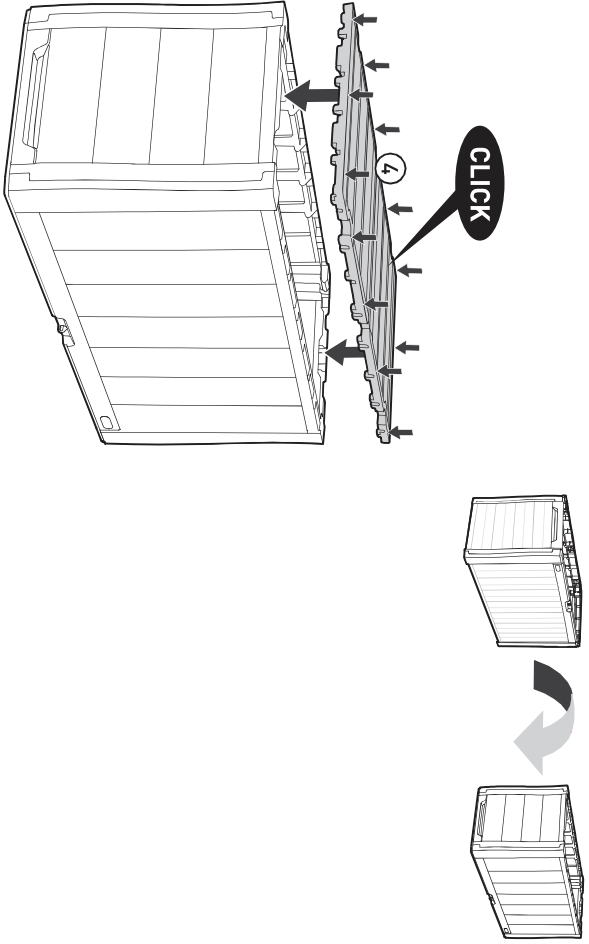

- 4 W (x2)

